



NOTICE

Notice is hereby given that the Mayor and City Council will hold a Work Session on January 11, 2012 in the Council Chambers, 45 West 100 South, beginning at 6:00 pm.

DISCUSSION ITEMS

1. Storm Drainage Agreement
2. General Discussion

If you are planning to attend this Public Meeting and, due to a disability, need assistance in understanding or participating in the meeting, please notify the City Office ten or more hours in advance and we will, within reason, provide what assistance may be required.

CERTIFICATE OF MAILING

The undersigned duly appointed City Recorder for the municipality of Santaquin City hereby certifies that a copy of the foregoing Notice and Agenda was e-mailed to the Payson Chronicle, Payson, UT, 84651.

By: Susan B. Farnsworth, City Recorder

Posted:
City Offices
Post Office
Zions Bank

**MINUTES OF A COUNCIL WORK SESSION
HELD IN THE COUNCIL CHAMBERS
JANUARY 11, 2012**

The meeting was called to order by Mayor James E. DeGraffenried at 6:00 pm. Council Members attending: Keith Broadhead, Matthew Carr, James Linford, Richard Payne, and Rick Steele.

Others attending: City Manager Ben Reeves, Legal Counsel Brett Rich, Franson Engineering Representative Jay Franson, Tod Rowley, Philip Rowley, Brent Norton, Norman Beagley, Filip Askerlund, Brent Vincent, Wade Eva, Jeremy Roos, and Jeremy Horton.

DISCUSSION ITEMS

Mr. Horton reviewed the way the audio of the meetings are obtained and stored. He indicted the system used by the City is also used by other Cities and experience few difficulties when storing the audio. Mr. Horton explained the recording of the November 28th Council Meeting experienced difficulties requiring reconstruction of the meeting audio. He attempted to reconstruct the audio using the program specific to the program used for recording the meetings. He said there appears to be missing audio but at this point it isn't obtainable. Council Member Broadhead recommended using a back up recording system to ensure this problem doesn't happen again. Mr. Roos commented that at the time the Council Meetings are broadcast this issue would resolve itself. Mr. Horton and Mr. Roos were thanked for attending the meeting this evening.

City Manager Reeves reported he had been contacted by a Utah County Representative to discuss the incident of discharge of Type 2 Water onto the Fowers Property. City Manager Reeves contacted the Division of Water Quality apprising them of the discharge issue. Division of Water Quality Representative Mr. Krauth requested City Manager Reeves draft a letter to the their office outlining the incident of January 10, 2012. A copy of the letter will be sent to Utah County Public Works, the Town of Genola, Fowers Fruit Growers, South Ridge Farms as well as Santaquin City's Mayor and Council Members. (See attachment "A" for a copy of the letter)

J-U-B Engineering Representative Mr. Beagley reported on the 400 East and Main Street Improvement Project. He indicted the project is 98% complete with the remainder being scheduled for completion in early Spring. He stated there were a number of agencies involved with the project. Mr. Beagley made note that the project was within the UDOT Right-of-Way, was funded by Utah County and managed by Santaquin City. He commented on the great job of Condie Construction as the project contractor. He wanted to thank Dennis Marker for his involvement in meeting with the property owners before the project began as well as being the "general go to person" throughout the entire project.

At the time Mr. Beagley presented a plaque to the Mayor and Council Members portraying the before and after of the project, he expressed his appreciation to Mr. Eva and the Public Works Crew for their in-depth knowledge and continual support during the project. City Manager Reeves thanked the J-U-B Employees for their dedication to the project. (See attachment "B" for a Status of Estimated Project Costs)

Storm Drainage Agreement

Mr. Franson addressed the Mayor and Council Members with regard to storm drainage. He indicated the cooperation shown with the Main Street Project is being carried over to the storm drainage project. Many meetings involving Representatives of Summit Creek Irrigation, Santaquin City, Genola Town, Highline Canal, and Utah County have been held. Those meetings have produced an overall Master Plan and a draft Memorandum of Agreement, for each entity, pertaining to the Master Plan. Mr. Franson discussed recharging of the aquifer in times of abundant snow fall. Council Member Steele questioned how the water could be stored in "Our" aquifer instead of the water ending up in Utah Lake. Mr. Franson indicated through management of the recharge, the water will be kept for our use. Mr. Franson commented that all those who participate in the agreement would "hold the credits" for the stored water. He voiced his appreciation to all those individuals involved in the meetings and the discussions of potential storm water management. It was reported that Genola Town is reviewing the Memorandum of Agreement this evening during their Council Meeting. Summit Creek Irrigation approved the agreement during their meeting on Saturday; the Utah County Commissioners will be reviewing the agreement during their meeting held this month as will the Highland Canal Representatives. (see attachment "A" for a Facilities Map pertaining to the project)

City Manager Reeves stated the approval of the agreement will be presented in Resolution form at the February 18th meeting. Mayor DeGraffenried indicated there are individuals who are willing to participate monetarily in the project at the time the project is underway. City Manager Reeves thanked those who have participated in the discussions making sure this project continues to go forward.

General Discussion

Nothing

The meeting adjourned at 6:55 pm.

Minutes approved on January 18, 2012.

James E. DeGraffenried, Mayor

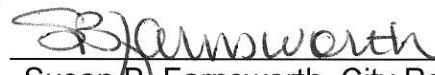
Susan B. Farnsworth, City Recorder

400 East and Main Street Improvements Status of Estimated Project Costs

Date Updated: 1/11/2012

Funding:

Includes:

Utah County funding	\$3,380,000
State funding for signal	\$200,000
State funding for Change in Taper	\$75,000
Santaquin Water Line Costs	\$50,948

Total Project Funding

\$3,705,948

Total Project Costs

Total Estimated Project Costs:

Includes:

Construction Costs
Engineering Costs
Right-of-Way Acquisition
Payment to Property Owners
Utility Relocation Costs
State Furnished Signal Materials
Services Provided by City
Use of land for stockpiling
Use of landfill
Business Sign Relocation

\$3,659,336

Estimated Amount of Remaining Funding

\$46,612

Percentage of Funding Utilized

98.74%

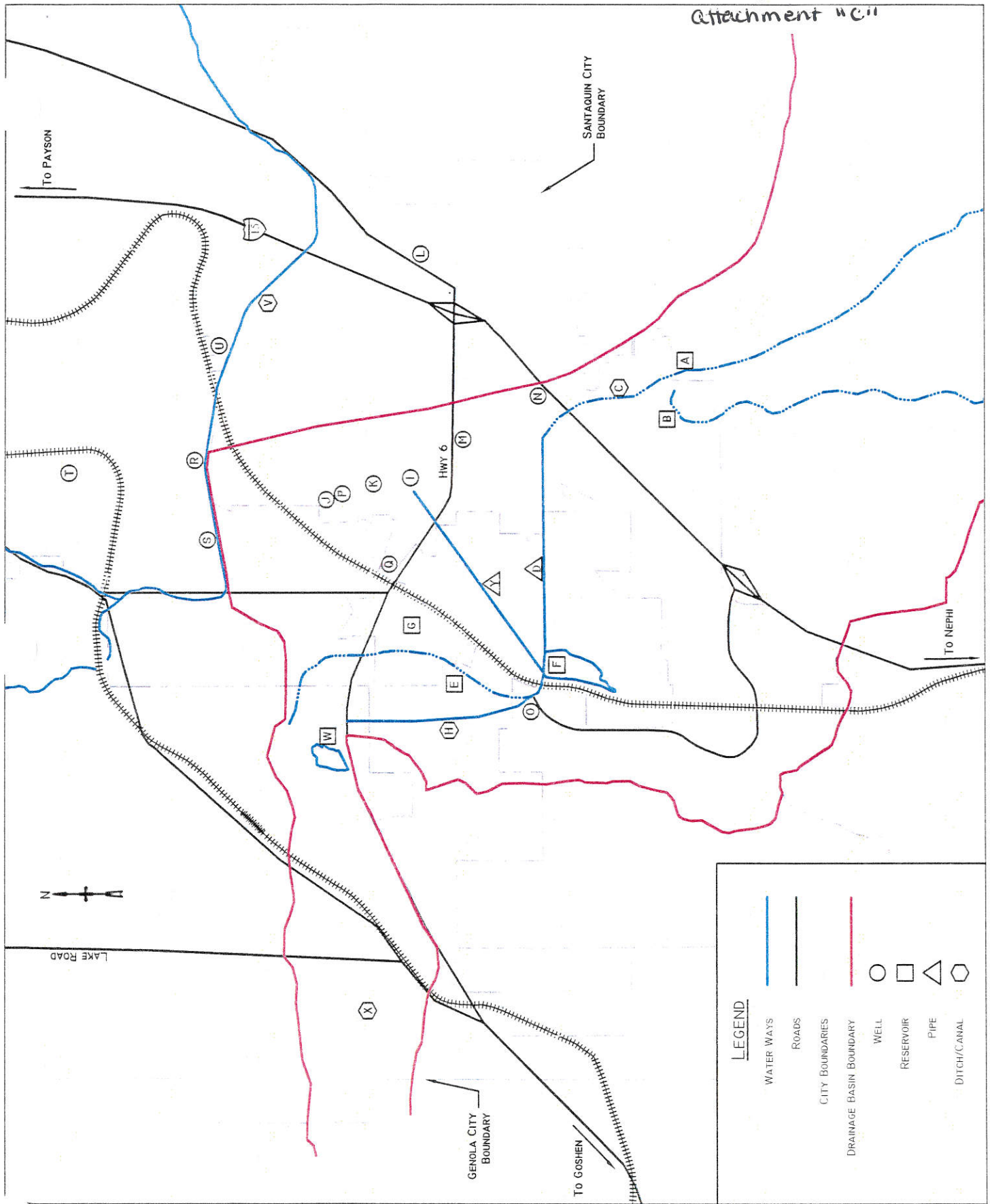

LEGEND

- WATER WAYS
- ROADS
- CITY BOUNDARIES
- DRAINAGE BASIN BOUNDARY
- WELL
- RESERVOIR
- △ PIPE
- ⬡ DITCH/CANAL

SUMMIT CREEK

FIGURE 2
FACILITIES



DATE: JANUARY 6, 2012
SCALE:
Location Map.dwg
H:\CLIENTS\2-Central Utah Area\Summit Creek
Irrigation Company\Dam - Phase 00\Drawings
LAYOUT: Layout1 (2)



January 11, 2012

Paul Krauth, Environmental Engineer
Utah Division of Water Quality
P.O. Box 144870
Salt Lake City, Utah 84114-4870

Re: Santaquin Winter Storage Pond #1 Discharge Incident

Mr. Krauth,

Yesterday, January 10th, 2012, Santaquin City became aware of an incident of sewer effluent discharge from the Santaquin City Winter Storage Pond #1. The purpose of this letter is to notify the Utah Division of Water Quality of the incident as well as the steps taken by Santaquin City in response to that incident.

Incident:

On Tuesday, January 10th, 2012, Santaquin City was contacted by John McMullin, Utah County Public Works Engineer, indicating that he was on his way to meet with Genola Mayor Danny Throckmorton and Lynn Fower of Fower's Fruit Growers with regard to water running onto the Fower's property. Mr. McMullin inquired if Santaquin City was discharging any water from its sewer lagoon facility. The initial response was "no" however Santaquin City Public Works Director, Wade Eva, went to the facility to investigate.

Upon arriving at the sewer lagoon facility, Mr. Eva found that water was in fact being discharged from the winter storage pond via gravity flow. Mr. Eva had found that the valve that allows for the normal and proper discharge of sewer effluent to our alfalfa fields during the regular irrigation season had been tampered with and opened.

It is important to note that during the second week of November, 2011, Public Works Supervisor, Jason Calloway and crew member Gregg Hiatt followed normal season end procedures to the alfalfa field discharge lines. This included the winterization of the alfalfa field

irrigation lines, draining of the discharge pump and lines, and the closure of the valve that opens water supply from winter storage pond #1 to the alfalfa fields.

Regretfully, it is also important to note that Mr. Eva indicated that the sewer pump house building has not historically been locked because the facility itself is secured by an exterior perimeter fence that always remains locked. With this admission, Mr. Eva also indicated that the sewer pump house had been vandalized on at least one prior occasion in the summer of 2011 when equipment stored in the facility was damaged. (e.g. a 4-Wheeler used in the alfalfa field operations had apparently been hotwired and used for a joyride by some suspected minors).

Regarding this incident, it is unknown as to when unauthorized access to the sewer pump house and tampering of the valve occurred. However, we believe that it took place between Tuesday January 3rd, 2012 (e.g. the last observation of the sewer facility by Mr. Callaway) and January 10th, 2012 (e.g. date of discovery of the water effluent discharge).

Due to the opening of the valve, the gravity flow of water effluent began. With the valve opened, fully processed Type II water effluent drained into a channel that flowed through lands owned by South Ridge Farms, Utah Department of Transportation, Santaquin City Landfill, and terminated on lands owned by Fower's Fruit Growers. (See attached map)

Mitigation Response:

- As soon as it was discovered that water was discharging from winter storage pond #1, the valve was turned off; thus stopping the flow of water.
- Santaquin City immediately contacted the Utah Division of Water Quality to verbally notify your office of the incident.
- Mr. Eva & Dennis Marker, Community Development Director, and Greg Flint, City Planner, took pictures and GPS the coordinates of the water discharge. (See attached pictures and map)
- Mr. Eva interviewed all Santaquin City Public Works employees to determine if any employee opened the valve or accessed the building. None of the employees indicated that they accessed the pump house during this period of time.
- Police Chief Dennis Howard was asked to open an investigation of the vandalism.
- Mr. Eva established a building security policy which requires that the sewer pump house remain locked at all times. In addition, chains and locks have been added to the valves to insure that they could not be opened in the future even if unauthorized access to the sewer pump house occurred.

- Santaquin City will evaluate the sewer lagoon site for the possible installation of a retention basin that would prevent the flow of sewer effluent off of Santaquin City property in the event that an incident occurs in the future.

It is unfortunate this event occurred. However, we believe that actions taken and the policies implemented have not only mitigated the damages that may have been caused by this incident, but more importantly will prevent the possibility of future incidents from occurring. Please let us know if you feel that further action is required by your organization.

Respectfully,

A handwritten signature in blue ink, appearing to read 'B. Reeves', with a stylized flourish at the end.

Benjamin A. Reeves
Santaquin City Manager

cc: Utah County Public Works
Town of Genola
Fower's Fruit Growers
South Ridge Farms
Santaquin City Mayor & Council

Incident Pictures:



Sewer Effluent Discharge Valve

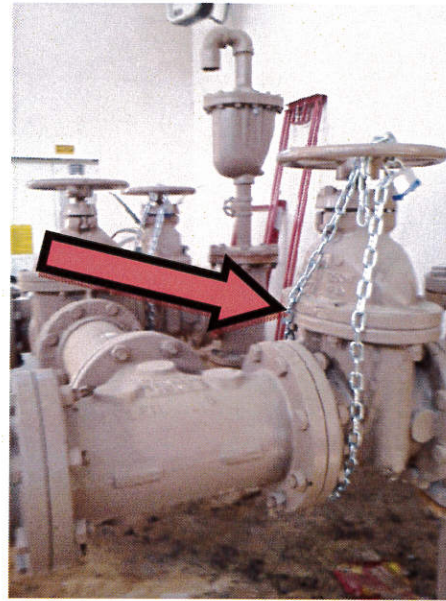

Locked Valves

Exhibit A

Pictures documenting flow path of discharged effluent water

Pictures taken on January 10, 2012 between 1500 and 1630 hours, except as noted



Looking north toward Drain Valve where discharge occurred. (Santaquin City Property)



Looking north along flow path and saturated area around discharge point.



Looking south along flow path toward discharge point (noted by arrow).

No visible running water. Pooling "wet" spots in picture are remnant ice patches. (Approx. 150 feet From Discharge Point (FDP)).



Looking north along flow path
(approximately 150 feet FDP) near
the point where discharged flows
entered natural runoff channel.



Looking south from intersection of
discharge flow path and natural
runoff channel. (Winter storage
pond #2 embankment in the
background)



Looking south along natural runoff
channel (210 feet FDP)



Looking south along flow path (approx.. 400 feet FDP). Intersection of natural channel and farm road on Santaquin property.



Looking northwesterly from farm road. Natural channel course running toward north Santaquin property line and Rowley's South Ridge Farms property.



Santaquin side of fence line where discharged flows entered onto Rowley's South Ridge Farms property. (Approx. 485 feet FDP)



Looking south toward fence line and along flow path. (Rowley's South Ridge Farms property at approx. 530 feet FDP) Pooling "wet" spots in picture are remnant ice patches with some small, isolated pooling areas.



Looking north along natural runoff channel and flow path. No flowing water visible under the ice at 1630 hours (arrows indicate investigation points)



Looking north along natural runoff channel and flow path (approx. 720 feet FDP)



Looking north along natural runoff channel and flow path.



Area of pooling within the flow path, near the north end of Rowley's property (approx. 1230' from FDP)



Looking north toward Highway 6 embankment. Flow begins braided stream pattern. No visible flow of water occurring under ice (approx. 1280 feet FDP).



Seperated streams converge again at north property line and enters Highway 6 culvert. Area of pooling. Approx. 1390 feet FDP.



Looking south from Lark Lane toward Highway 6 embankment and along natural runoff channel.



Looking north into runoff channel culvert under Lark Lane. Small amounts of flow happening in to the culvert. Picture taken around 1530 hours.



Looking north onto the Fowers' property and along the runoff course. Picture taken from Lake Lane road grade.



Discharged water flowing out of culvert and onto the Fowers' property.



Looking north along flow path from culvert under Lark Lane.



Looking northeasterly along flow path (approx. 230 feet from Lark Lane culvert; i.e. Fowers' south property line).



Looking northeasterly along flow path
(approx. 370 feet along the flow path
from Lark Lane culvert; i.e. Fowers' south
property line).



Looking northwesterly along flow path.
(Approx. 625 feet along flow path inside
Fowers' property.)



Looking southeasterly along the flow
path from same spot as previous picture.



Looking northwesterly along flow path through Fowers' property (approx. 760 feet along path inside Fowers' property).



Looking southeasterly along flow path through Fowers' property (approx. 800 feet along path inside Fowers' property).



Looking southeasterly along flow path through Fowers' property (approx. 950 feet along path inside Fowers' property).



Looking northwesterly along flow path through Fowers' property (approx. 950 feet along path inside Fowers' property).



Wade Eva (left) and Greg Flint at flow terminus as of 1630 hours on January 10, 2012. Looking southeasterly.



Greg Flint, surveying flow terminus as of 1630 hours on January 10, 2012. Approximately 1,025 feet along flow path from entrance onto Fowers' property. Approximately 2,850 feet from discharge point.



Looking west along anticipated direction of flow. As of 1630 on January 10, 2012 there was minor flow of water still occurring.



Picture taken January 11, 2012. Looking southeasterly toward surveyed flow terminus on January 10, 2012 (Indicated by arrow). Water has flowed as expected, through natural runoff channel.



Looking westerly at new point of terminus (shown in foreground, blue) as of January 11, 2012, 1230 hours. There was no observed flowing of water along the flow path. Minimal expansion of flow path anticipated.

New point is approximately 100 feet west of previously surveyed point (shown in background, red)

